

Autonomous

SmartDesk 5

Assembly Guide

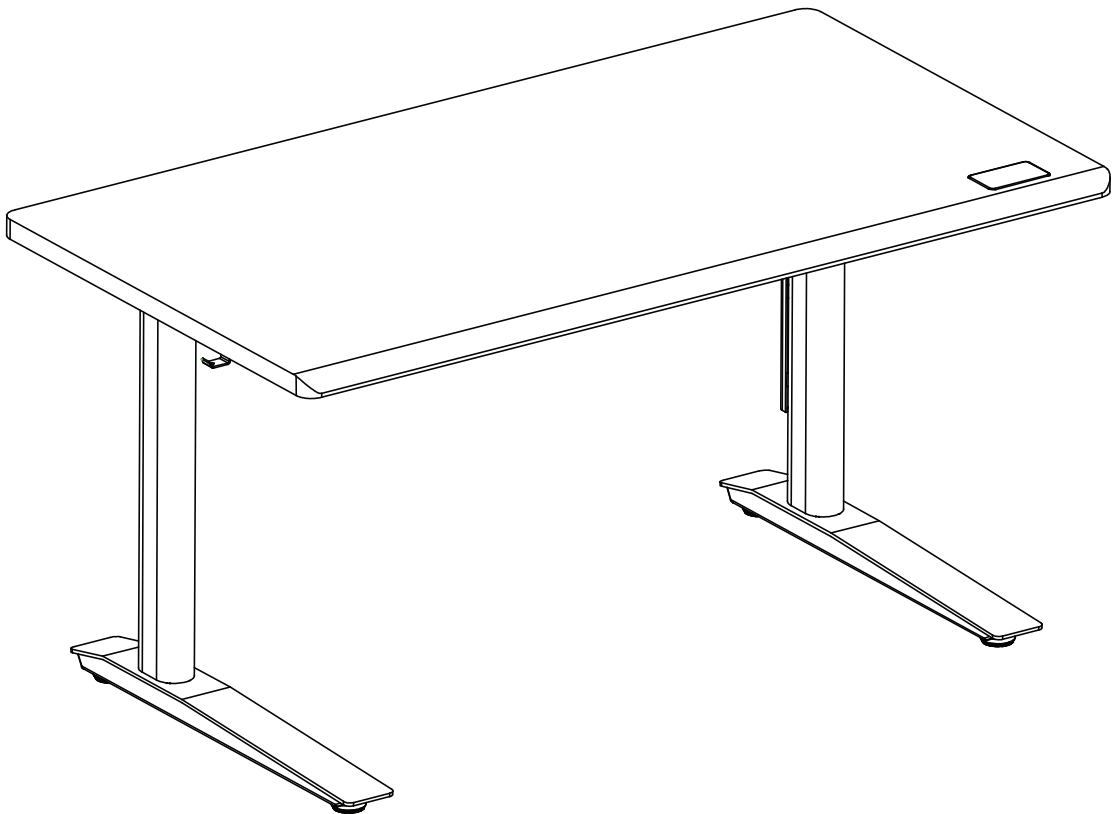

Caution

Safety reminders

To ensure everyone's safety, please keep children, pets, and others away from the product while in use.

Powering down

When not using the product for long periods of time or during a lightning storm, please unplug the power supply to avoid any accidents.

Setting up your space

Place your desktop at a safe distance from walls to ensure proper ventilation and to prevent any damage.

Clear the way

Make sure the product is clear of obstacles during operation, and keep the area under the desktop clear of obstacles over 20 inches high.

Perfect environment

To keep your product running smoothly, please keep it in a room with a temperature between 0-40°C. Also, keep it away from corrosive substances and dusty objects.

Safety first

Please don't disassemble the product without permission, as this can cause malfunction or harm. Even with our safety features, please keep your hands and body parts in a safe position to avoid harm.

Getting started

Before using the product, carefully read the instructions for assembly. We want to make sure you have a great experience with our product!

Resetting the product

After first use or a power failure, you'll need to manually reset the product before using it again. Don't worry, it's easy!

By following these simple guidelines, you'll be able to enjoy your product while staying safe and secure. Happy using!

Assembly Time

15-30 min

Self-assembly

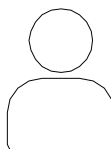

Tools Needed

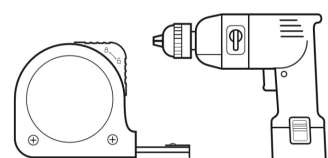

Parts included

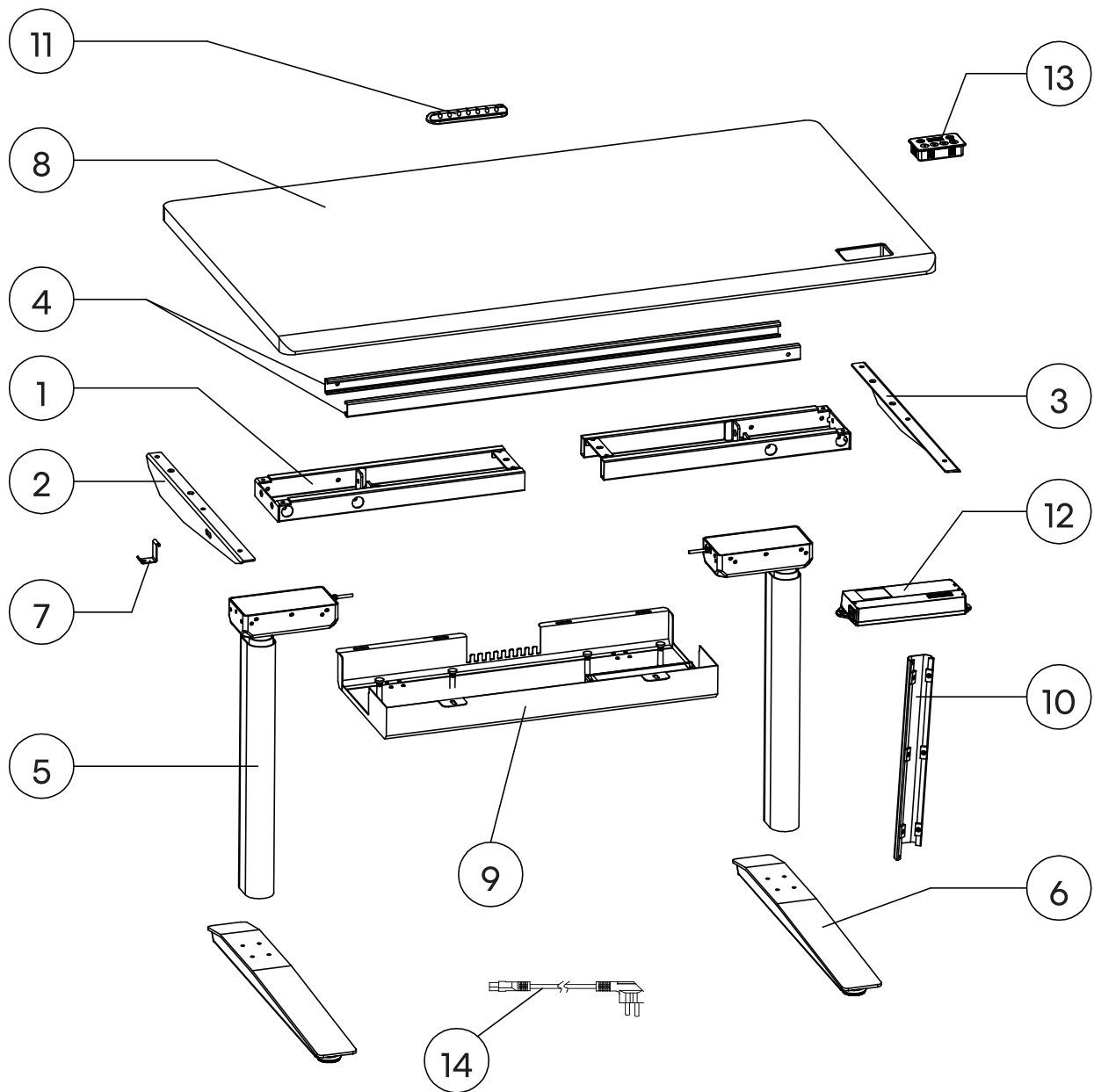

A M6 x 10 Screws

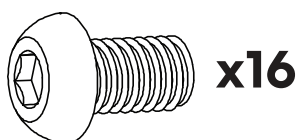

B M6 x 14 Screws

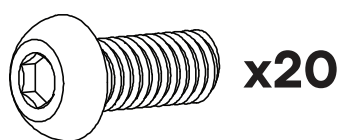

C M6 x 12 Screws

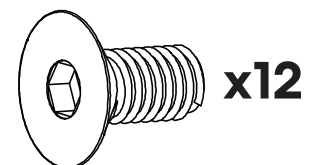

D M4 Wrench

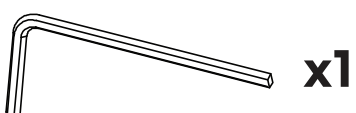

E M6 x 10 Hand screw

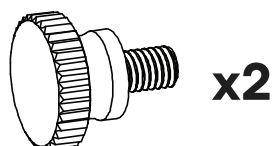

F Zip Ties

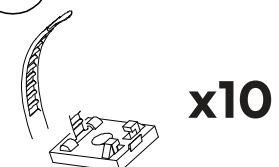

Instructions

Step 1 Put the Columns (5) and the Frame (1) together with the wrench and the 8 (A&C) screws.

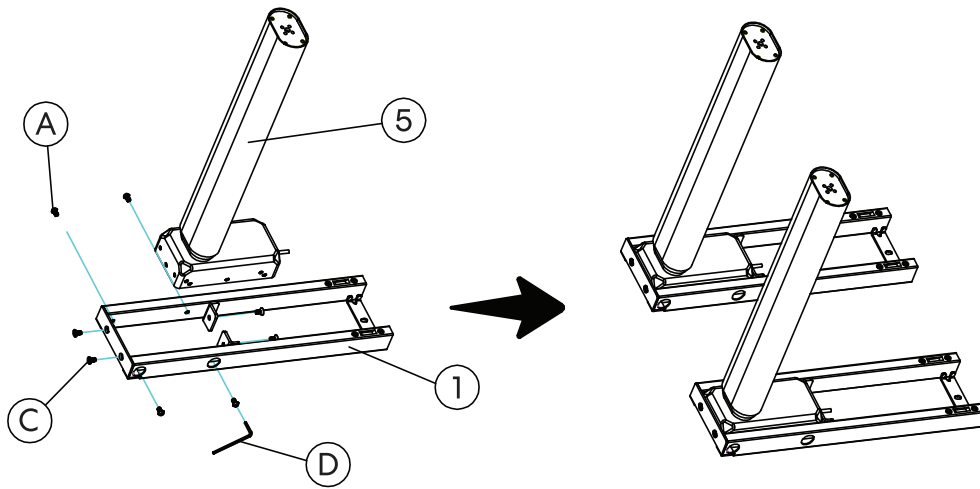

Step 2 Put the Feet (6) and the Columns together (5) with the wrench and 8 (B) screws.

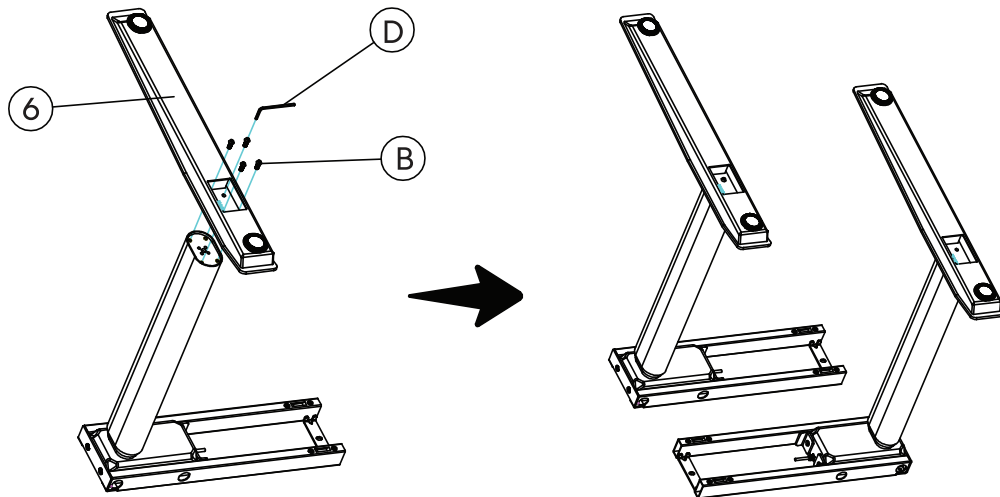

Step 3 Put the center rail (4) and the frame (1) together. Do not place the screw in yet.

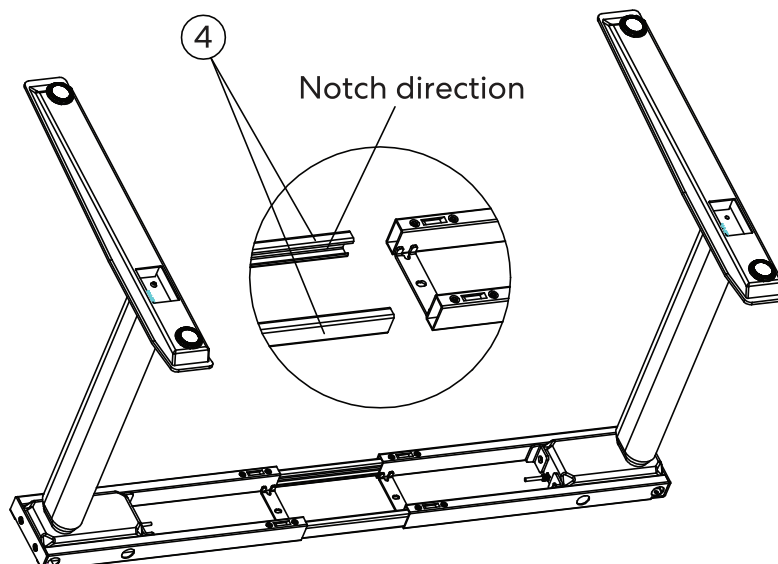

Step 4 Attach Side Bracket A (2) and Side Bracket B (3) to the frame (1) with the wrench and 2 (C) screws.

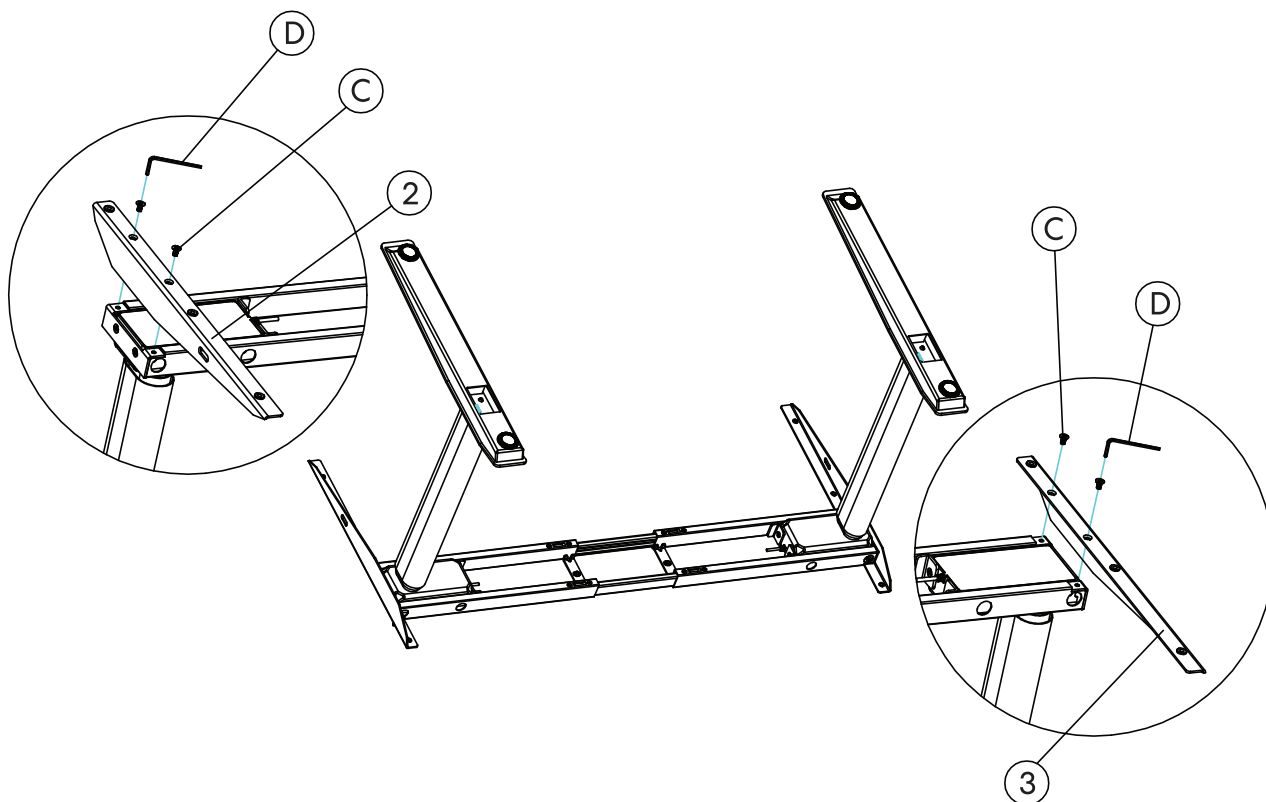

Step 5 Assemble the Center Rail (4) to the frame (1) with the wrench and 8 (A) screws. Align the holes in the side bracket of the leg assembly with the holes shown on the desktop. Use the wrench and the 8(B) screws to insert the whole frame to the desktop.

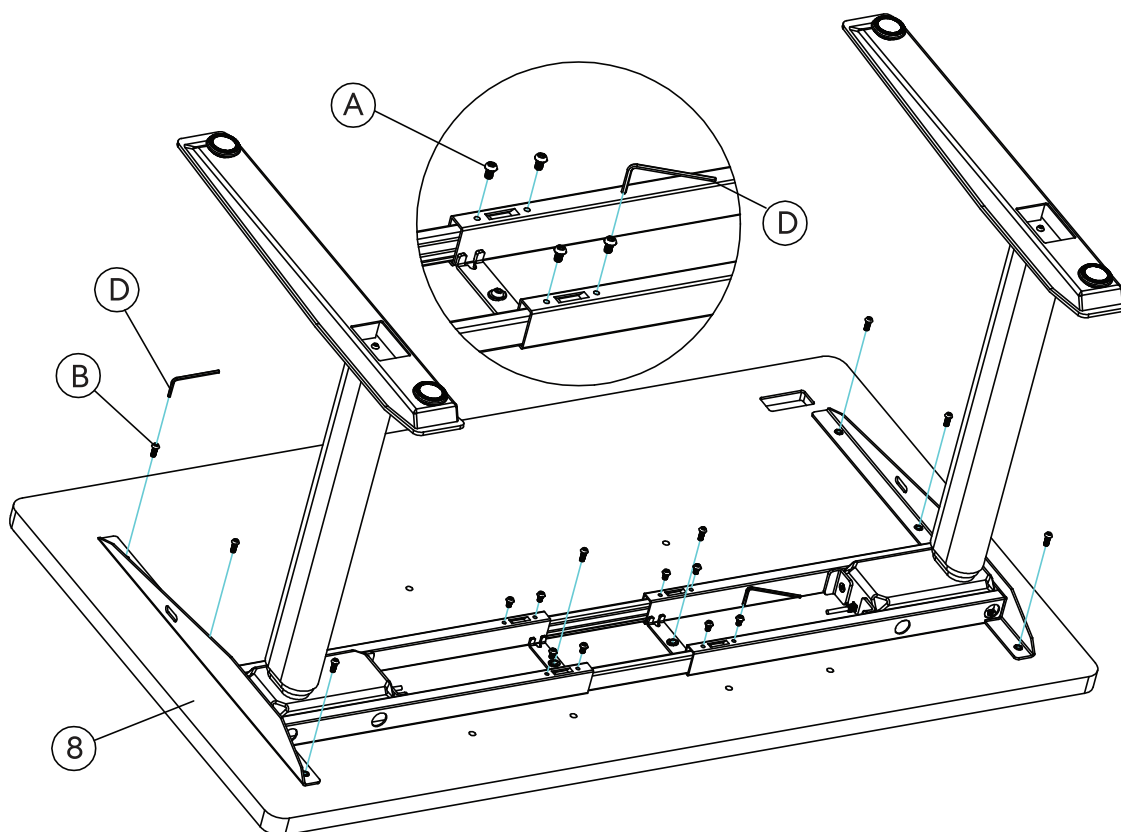

Step 6 Plug the motor cords , keypad cord (13), and power cord (14) to the control box (12). Then, wrap the cords around the cable winder for optimal organization.

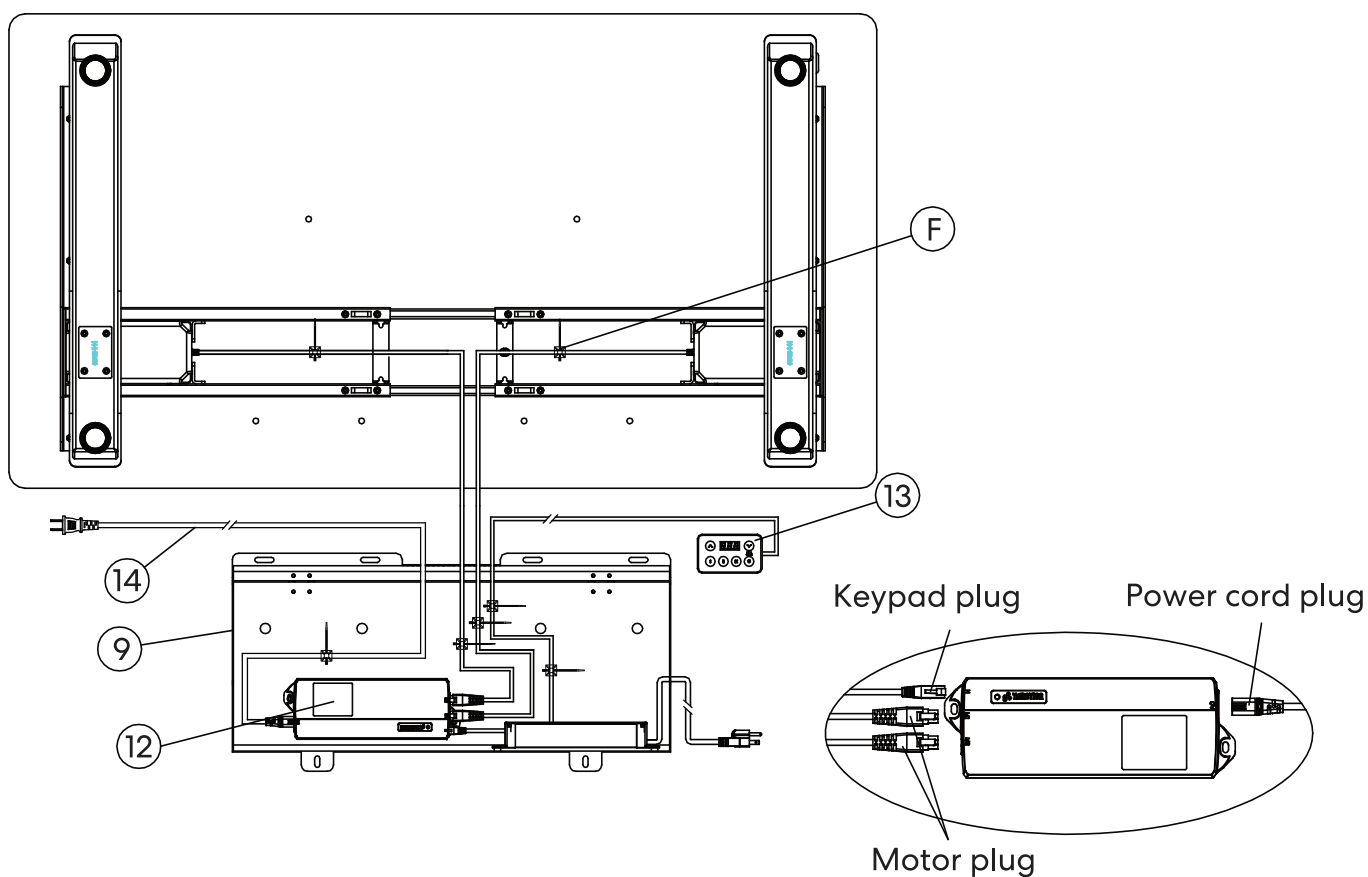

Step 7 Use the Wrench and the 4x(B) and 2x (E) hand screws to assemble the cable tray to the desktop.

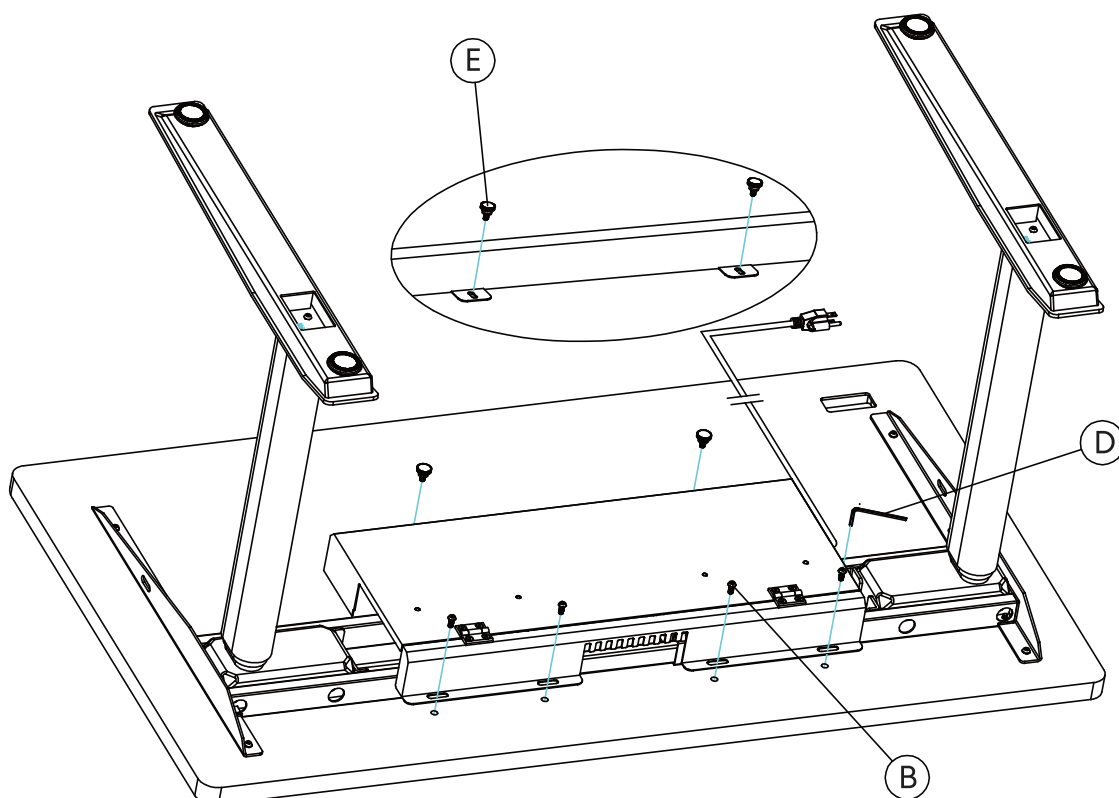

Step 8 Attach the Upper Tube (10) to one of the columns (5) and then attach the cable organizer (11) to the back edge of the desktop.

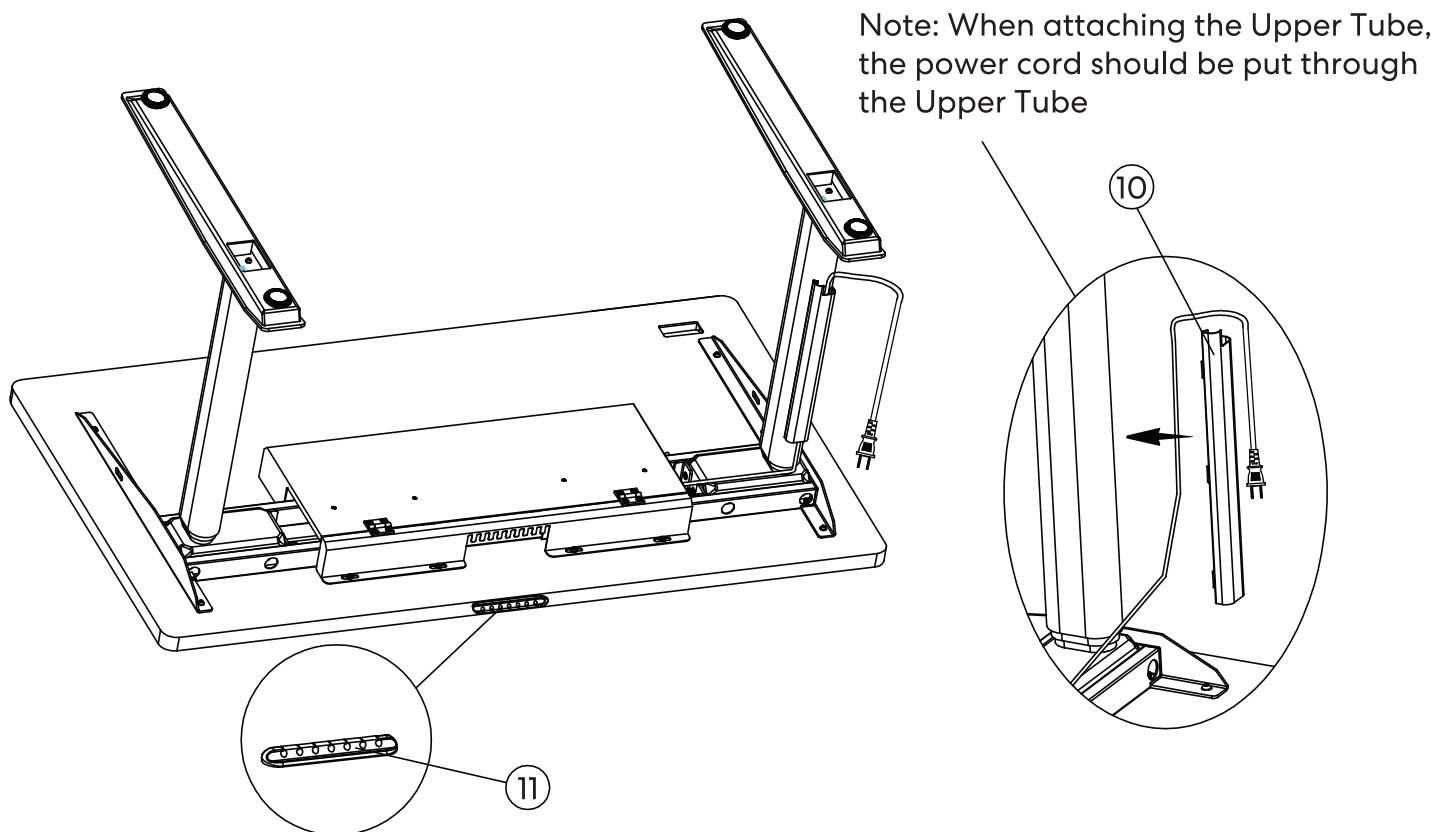

Step 9 Take a moment to double check that all screws are tight. Then carefully flip up.

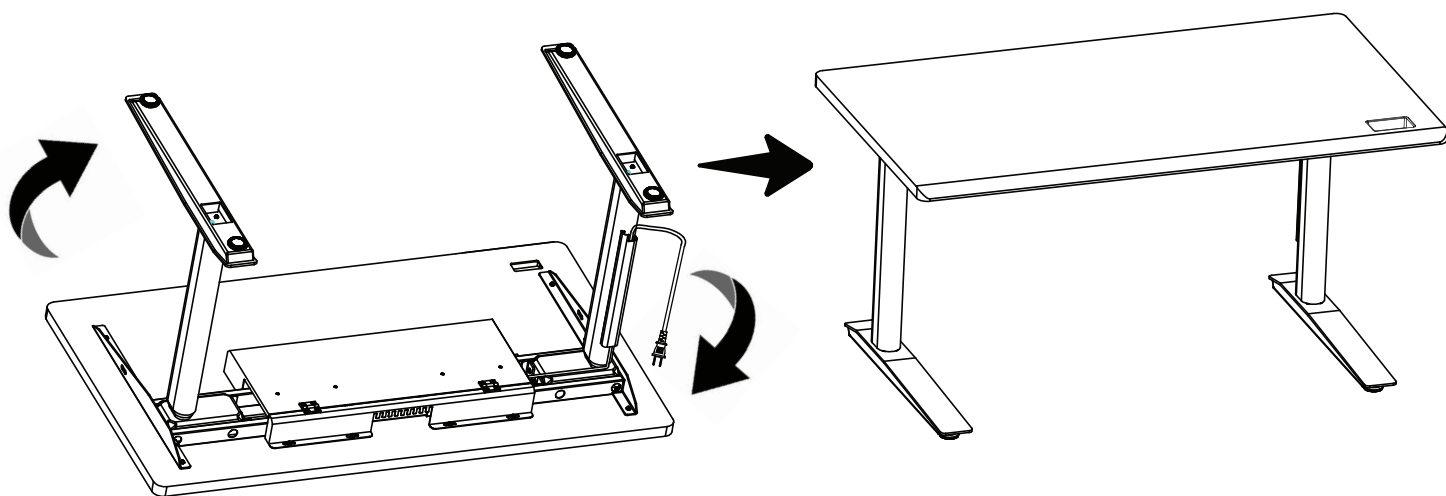

Step 10 Disconnect the keypad cable (13), route it through the desk top, and reconnect it to the control box.

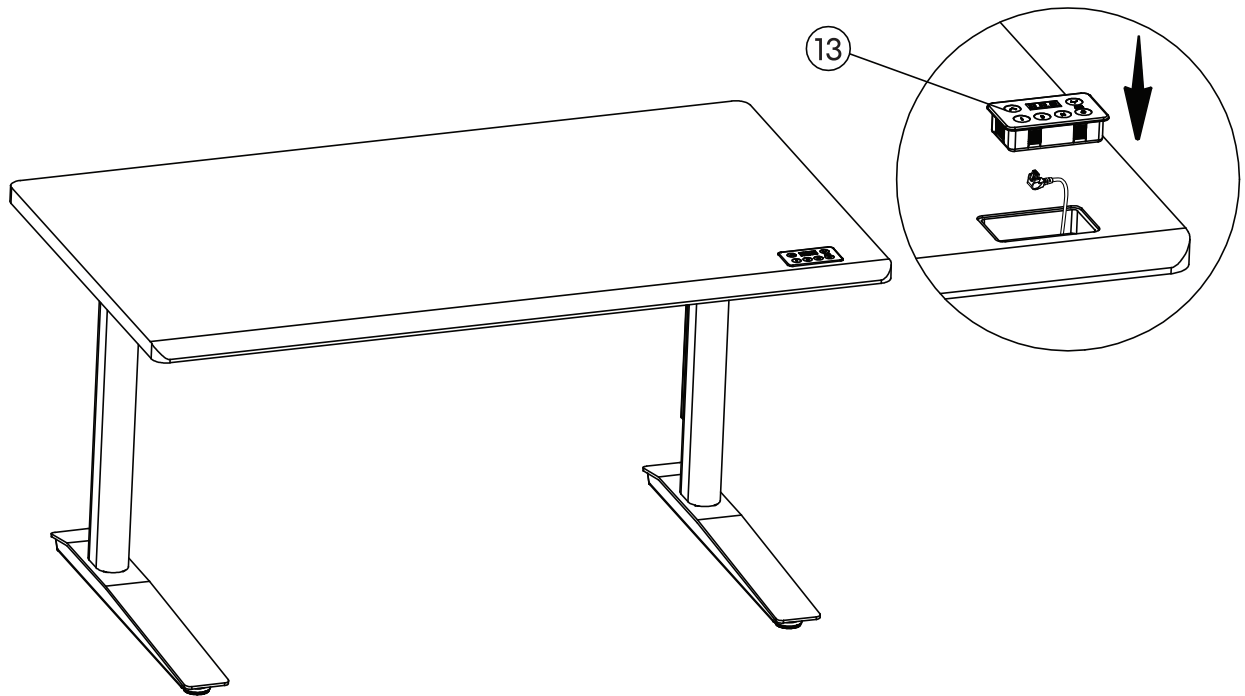

Step 11 Put 2 hooks (7) onto Side Bracket A and Side Bracket B.

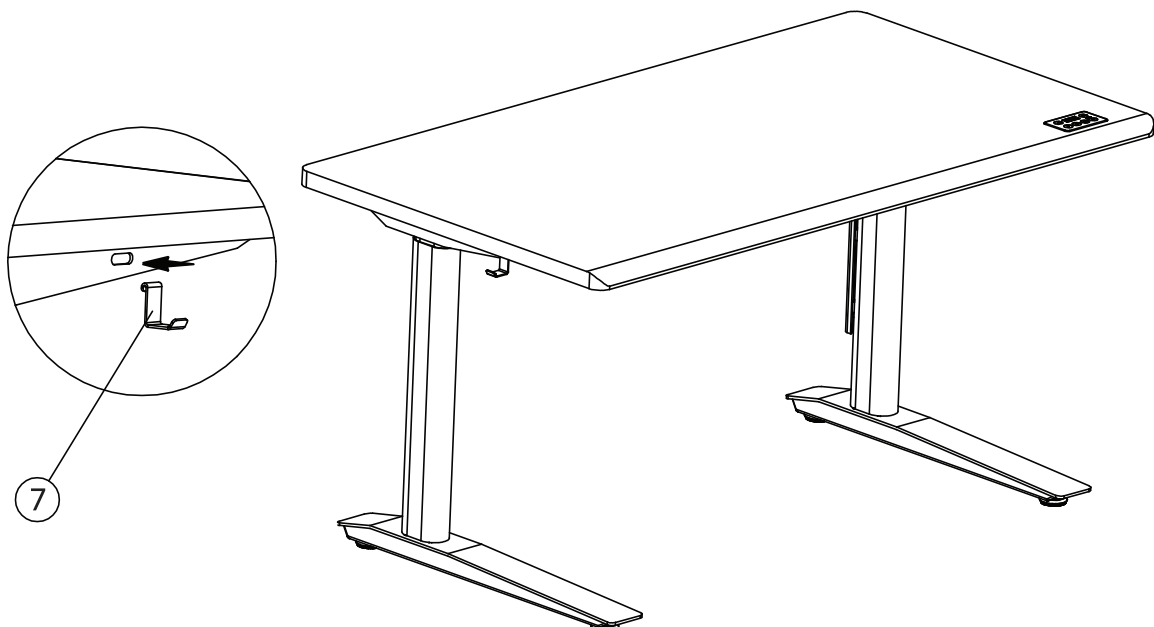

Step 12 Prepare Your Desk

Press and hold the up and down buttons for 3 seconds. The column will move down. Release when 'E00' flashes, indicating the reset is complete.

Step 13 Set Your Anti-Collision Level (*)

1. Press I + II together for 5 seconds to enter setting mode. Then, press up and down to adjust sensitivity: 0 (off), **1 (Setting 1, HIGHLY recommended)**, 9 (max).
2. Press I + II together for 5 seconds to save the desired level. Then, unplug and replug the power cable. The desk will reset, and it's ready for use.

(*) The Anti-collision setting prevents damage and accidents by stopping the desk if it hits something, becomes uneven, or tilts.

User guide

Adjust the height

Press the up and down buttons until the desk reaches the preferred position.

Memory height setting

1. Adjust the desk to the desired height.
2. Press and hold the “M” button for three seconds until the display flashes, then press the memory button I, II, or III that you’d like to save.
3. Click the digital button that is already set to the memory position and the desk will automatically move to the saved height position.

Any questions?

Chat with our Customer Support team at www.autonomous.ai/help-center.

We're here to help!