

# SmartDesk Junior

## Assembly instructions

I'm a desk you  
won't outgrow.

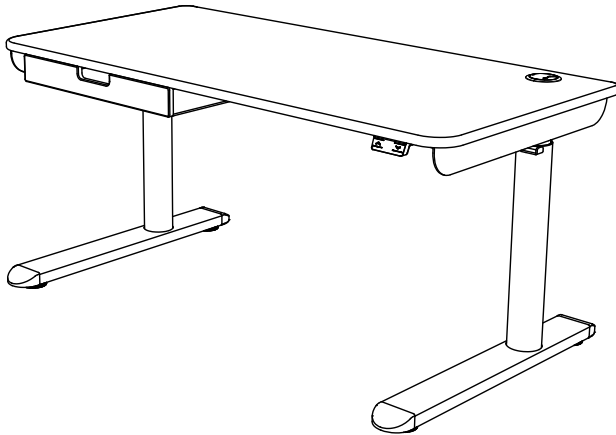

**Autonomous**

# Parts included in the boxes

A. Leg	x2	F. Control Keypad	x1
B. Support Beam	x1	G. Power cord	x1
C. Bracket	x2	H. Cable Tray	x1
D. Foot	x2	Z. Desk top & drawer	x1
E. Control Box	x1	(separate box)	

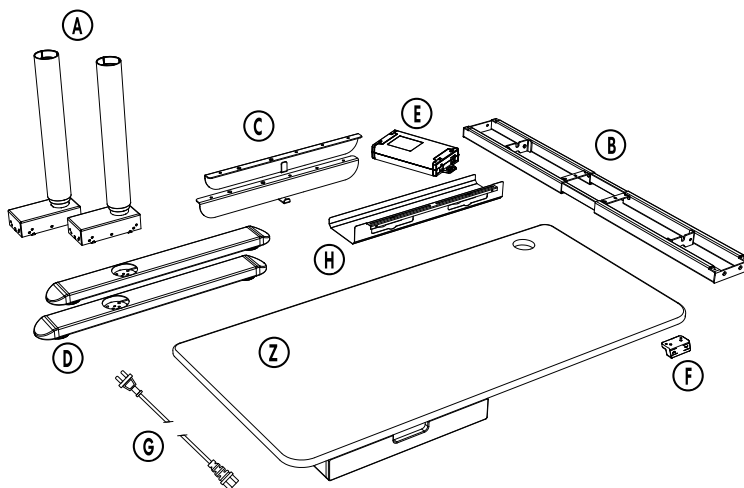

## Hardware pack



**I.**  
M6 x12



**J.**  
M6 x4



**K.**  
Gasket x4



**L.**  
Spring  
cushions x4



**M.**  
M8 x8



**N.**  
Rubber  
cushion x12



**O.**  
ST3.5 x2



**P.**  
ST4.8 x14



**Q.**  
4mm hex  
key x1



**R.**  
5mm hex  
key x1

## Tool needed



**Screwdriver**  
(not included)

# 1.

Loosen the 8 M6 screws already attached on the support Beam (B) using the 4mm hex key (Q). Adjust the beam's length to fit the desk top.

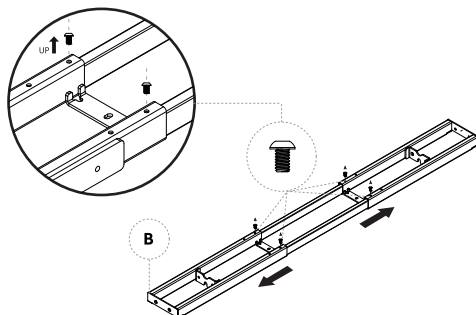

# 2.

Attach the 2 legs (A) to the support beam using 8 M6 screws (M) and the 4mm hex key (Q).

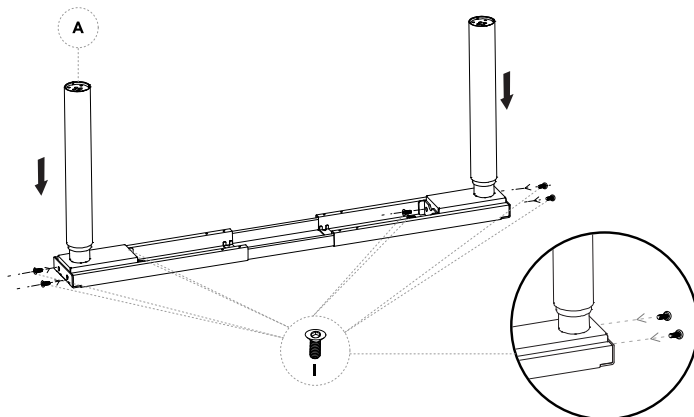

# 3.

Attach the 2 feet (D) to the support beam using 8 M8 screws (M) and the 5mm hex key (R).

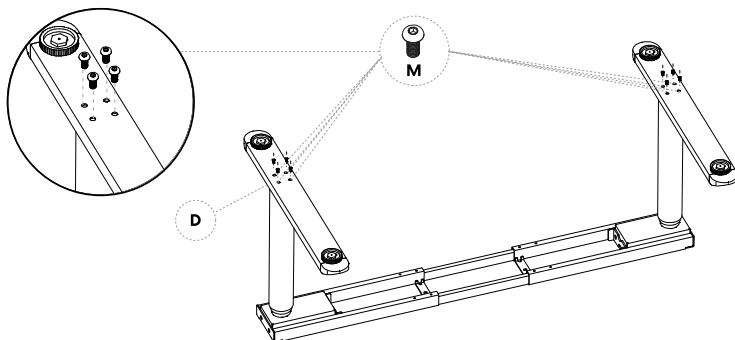

## 4.

Flip the frame and attach the 2 brackets (C) to the support beam using 4 M6 screws (I) and 4mm hex key (Q).

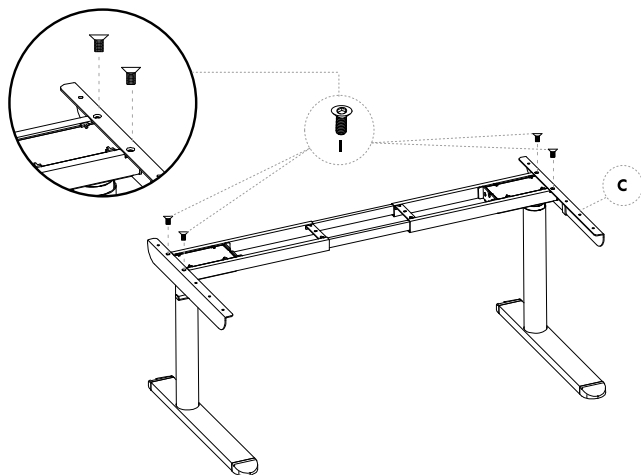

## 5.

Attach the 12 rubber cushions (N) to the brackets (C) and support beam (B).

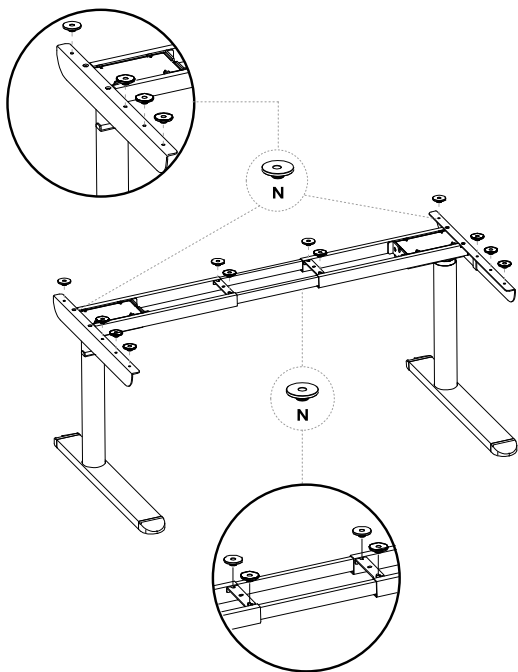

## 6.

Unscrew the 2 M6 screws already attached on the support beam (B) using the 4mm hex key (Q). Install the cable tray (H) on the support beam (B) and tighten the M6 screws (J) on the gaskets (L) and on the spring cushions (K).

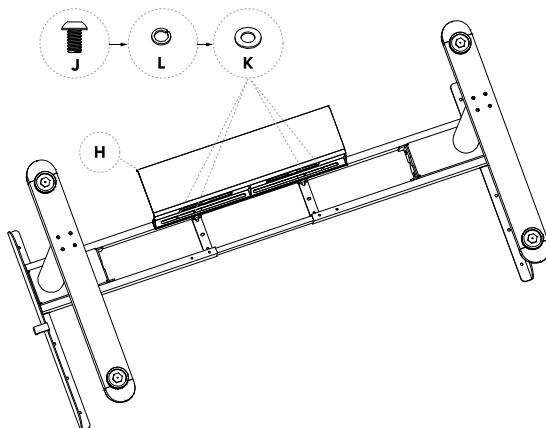

## 7.

Fix the desk top to the support beam (B) using 12 ST4.8 screws (P). Then, attach the control box (E) below desk top with 2 ST4.8 screws (P). Attach keypad (F) below desk top with 2 ST3.5 screws (O).

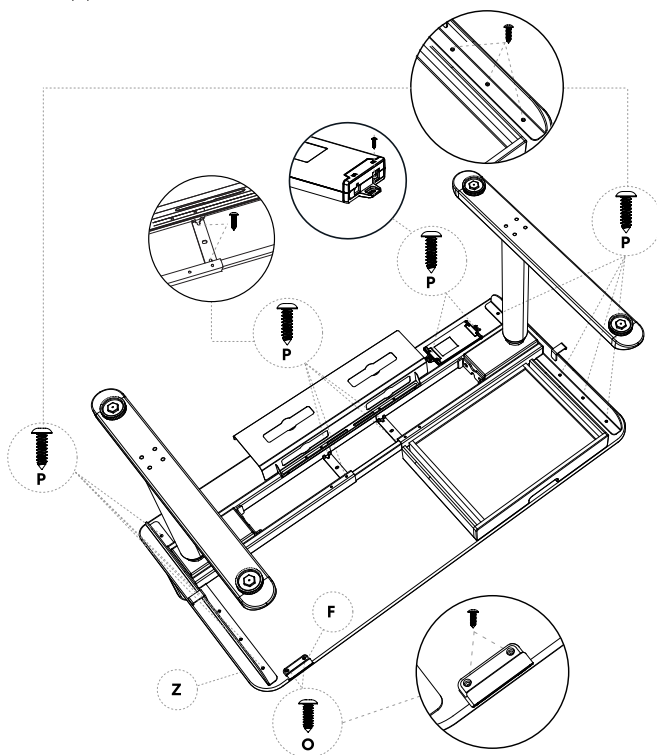

## 8.

Connect the control box (E) to the keypad (F) and to the motor on the legs (A).

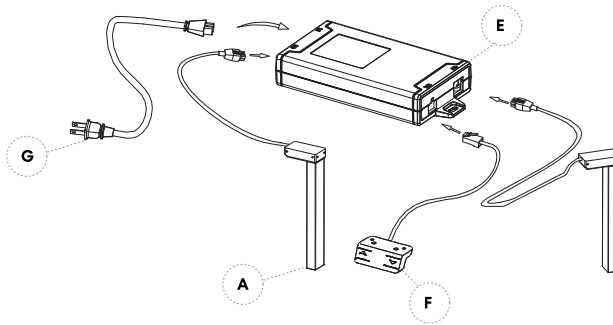

 NOTE: Make sure no obstacles are in the desk's path. Make sure cords are a length that will accommodate the change in height.

## 9.

Before use, reset the control box by following these instructions on the keypad:

**9.1)** Press and hold the down button until the frame reaches the lowest position.

**9.2)** Then press and hold the down button for 5 seconds until you hear a beep.

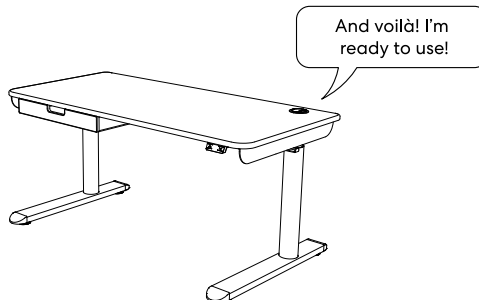
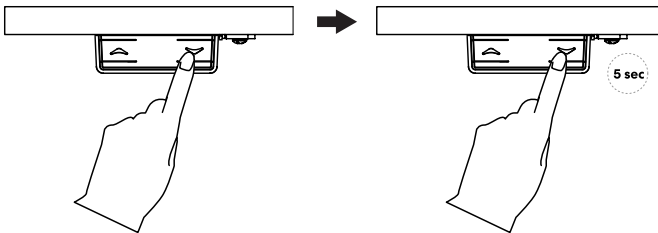

# INSTRUCTIONS FOR USE

## 1. Adjust SmartDesk's height

Press "Up" or "Down" button to adjust the height of the desk.

## 3. Reset the desk

Unplug the power cord to the control box.  
Unplug the cable from the keypad to the control box.  
Plug all the cables again.  
Do the reset:

- 1 .Press and hold the down button until the frame reaches the lowest position;
- 2.Then press and hold the down button for 5 seconds until you hear a beep.

### Before use make sure that:

The legs are level and start at the lowest position.  
All the screws are tightened or else the desk will make noise/ wobble.

## DESK PLACEMENT

When moving the desk, DO NOT lift the desk by the desktop alone. Support both the frame and the desk top equally. Favoring one over the other can stress the fasteners connecting the desk frame to the desktop. Lower the desk completely before moving it.

Choose a placement for the desk that's a safe distance from window frames, radiators, furniture, etc., so that people do not get stuck or trapped by the desk, and nothing obstructs the desk from rising or lowering.

Ensure adequate cord clearance before using the desk. Connect desk's power cord to the **110V - 240V** outlet to make the desk ready for use.

Do not place any objects underneath the desk that are taller than 25".

---

## ABOUT

Autonomous is a global network of innovators. We're engineers who take apart your day, examine the pieces, and then reassemble your routine to help you #worksmarter. Our sole focus is towards realizing the gold standard of the smart office industry.

**Visit:** [www.autonomous.ai/warranty](http://www.autonomous.ai/warranty).

**$\lambda$ utonomous**