

Autonomous

SmartDesk 2

Assembly & Instructions

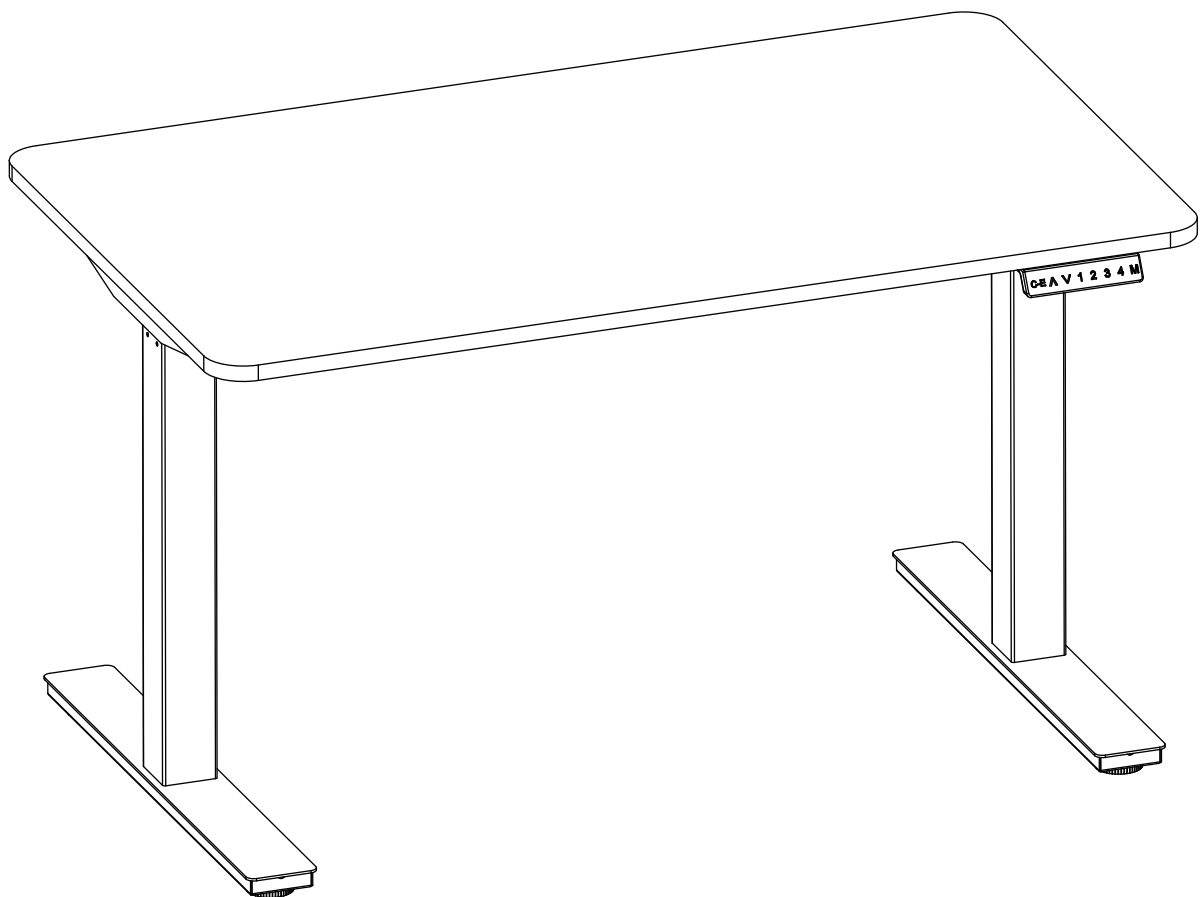

Parts

TOOLS REQUIRED

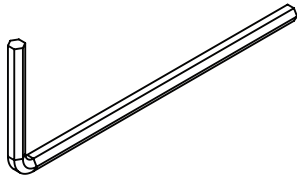

4mm Allen Wrench
(included)



Screwdriver

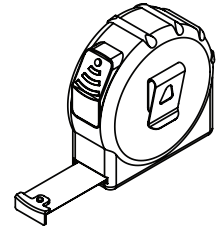

Tape Measure

COMPONENTS

1

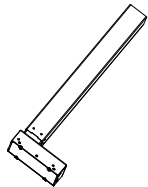

Leg x2

2

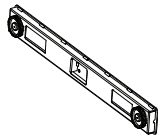

Foot x2

3

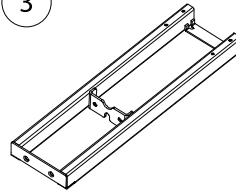

Crossbar End x2

4

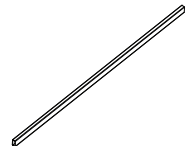

Crossbar Rail x2

5

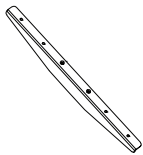

Side Bracket x2

6

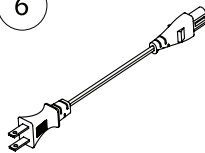

Power Cord x1

7

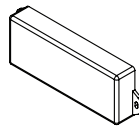

Control Box x1

8

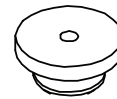

Noise Canceling
Pad x12

9

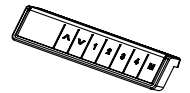

Keypad x1

HARDWARE

10

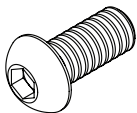

M8x16 x8
Machine Screws

11

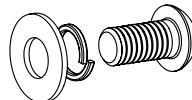

M6x12 x4
Combo Screws
of Cable Tray

12

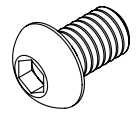

M6x10 x8
Machine Screws

13

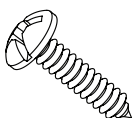

ST4.8x19 x14
Wood Screws

14

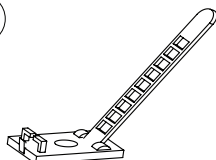

Cable Clips x10

15

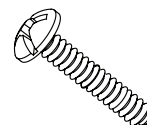

ST3.5x19 x2
Wood Screws

16

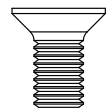

M6x12 x12
Machine Screws

Parts Diagram

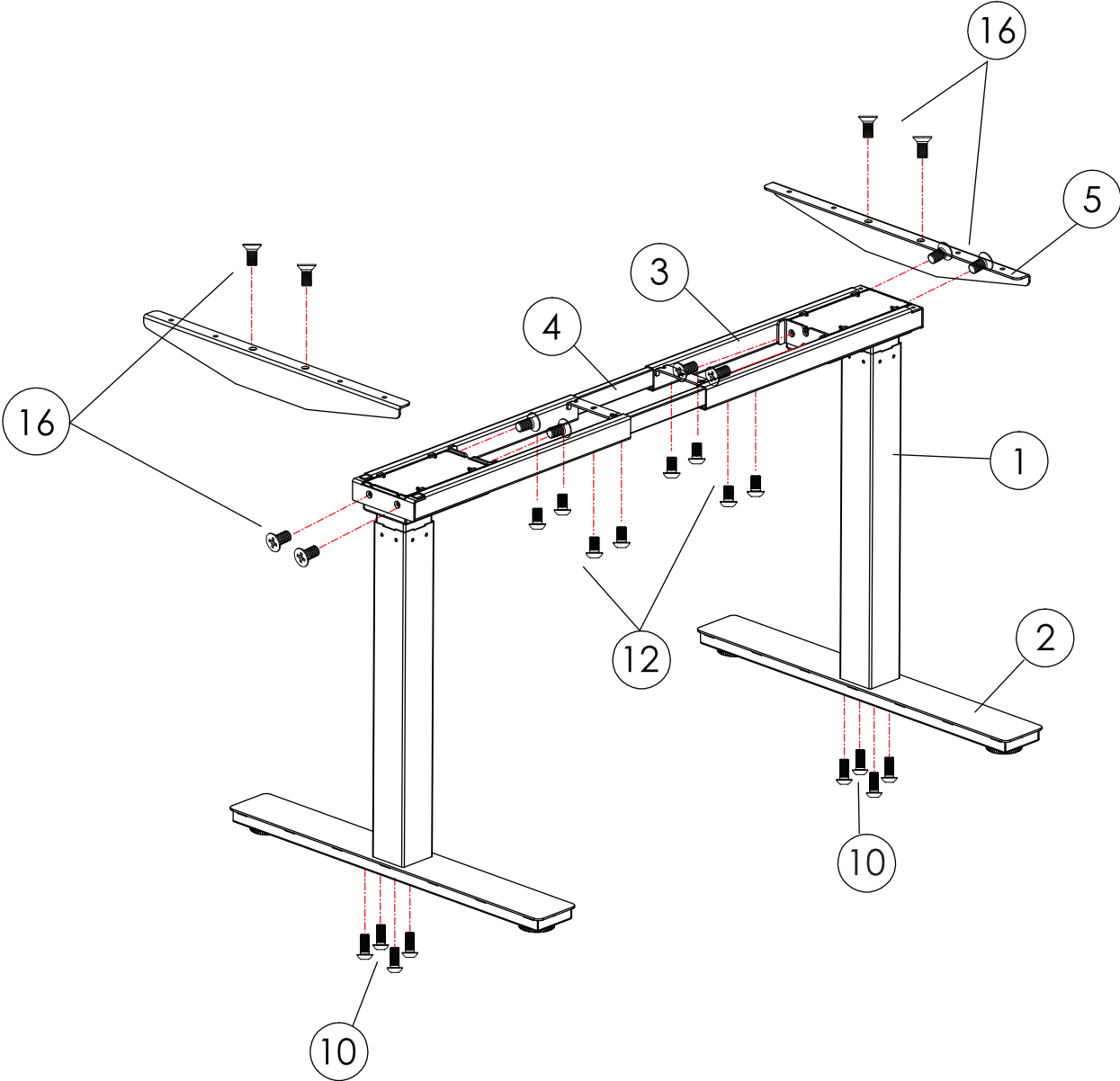

No.	Description	Qty	No.	Description	Qty
1	Leg	2	9	Keypad	1
2	Foot	2	10	M8x16 Screws	8
3	Crossbar End	2	11	Combo Screws of Cable Tray	4
4	Crossbar Rail	2	12	M6x10 Screws	8
5	Side Bracket	2	13	ST4.8x19 Wood Screws	14
6	Power Cord	1	14	Cable Clips	10
7	Control Box	1	15	ST3.5x19 Wood Screws	2
8	Noise Canceling Pad	12	16	M6x12 Screws	12

Step 1

Use the Allen Wrench to loosen eight M6x10 screws.
Separate the Crossbar Ends (P3).
You will find the Crossbar Rails (P4) inside.

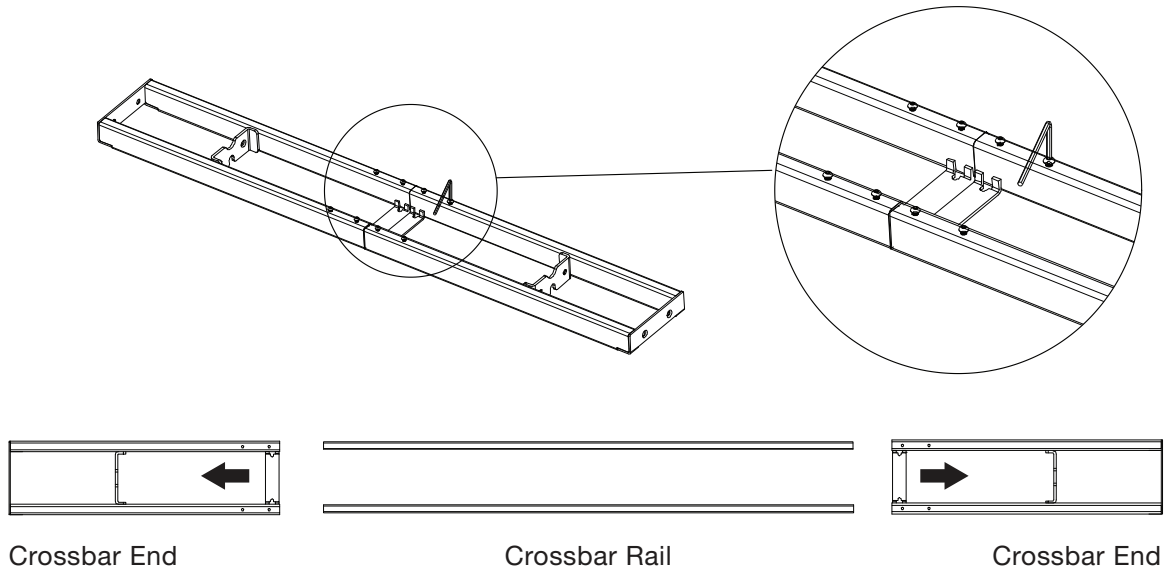

Step 2

Turn the Legs (P1) upside down on their sides.
Place the Crossbar Ends (P3) into the Legs following direction as below pictures.
When positioned correctly, the mount tabs of Crossbar Ends will be facing up.
Insert eight M6x12 screws (P16) into Crossbar Ends - 4 for each side.
Flip the Legs to gain access to all screws and firmly secure both legs.

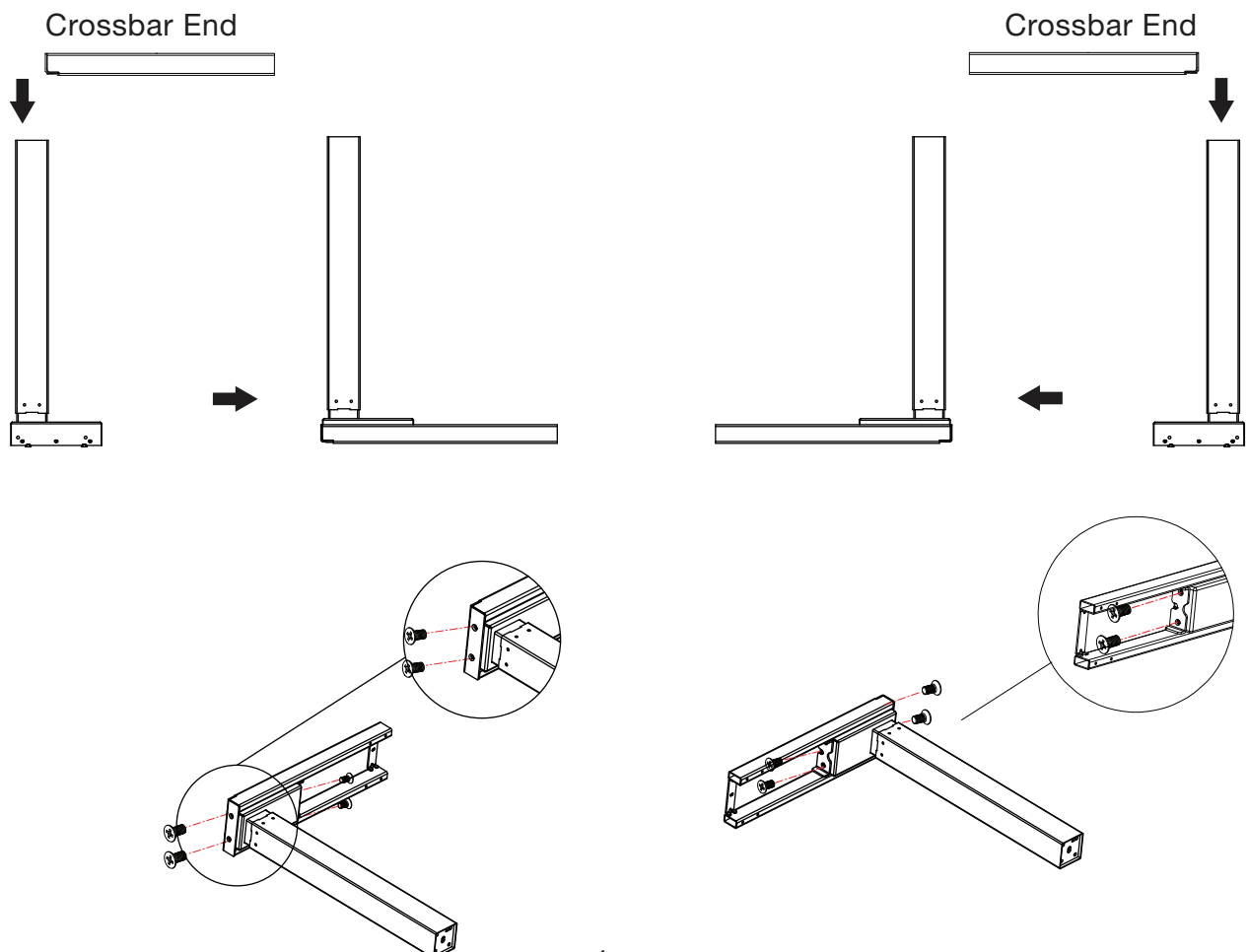

Step 3

Attach two Side Brackets (P5) to either side of the Legs assemblies.
Insert four M6x12 screws (P16) into Side Brackets.
Once all of the parts are connected, you can now tighten all screws.

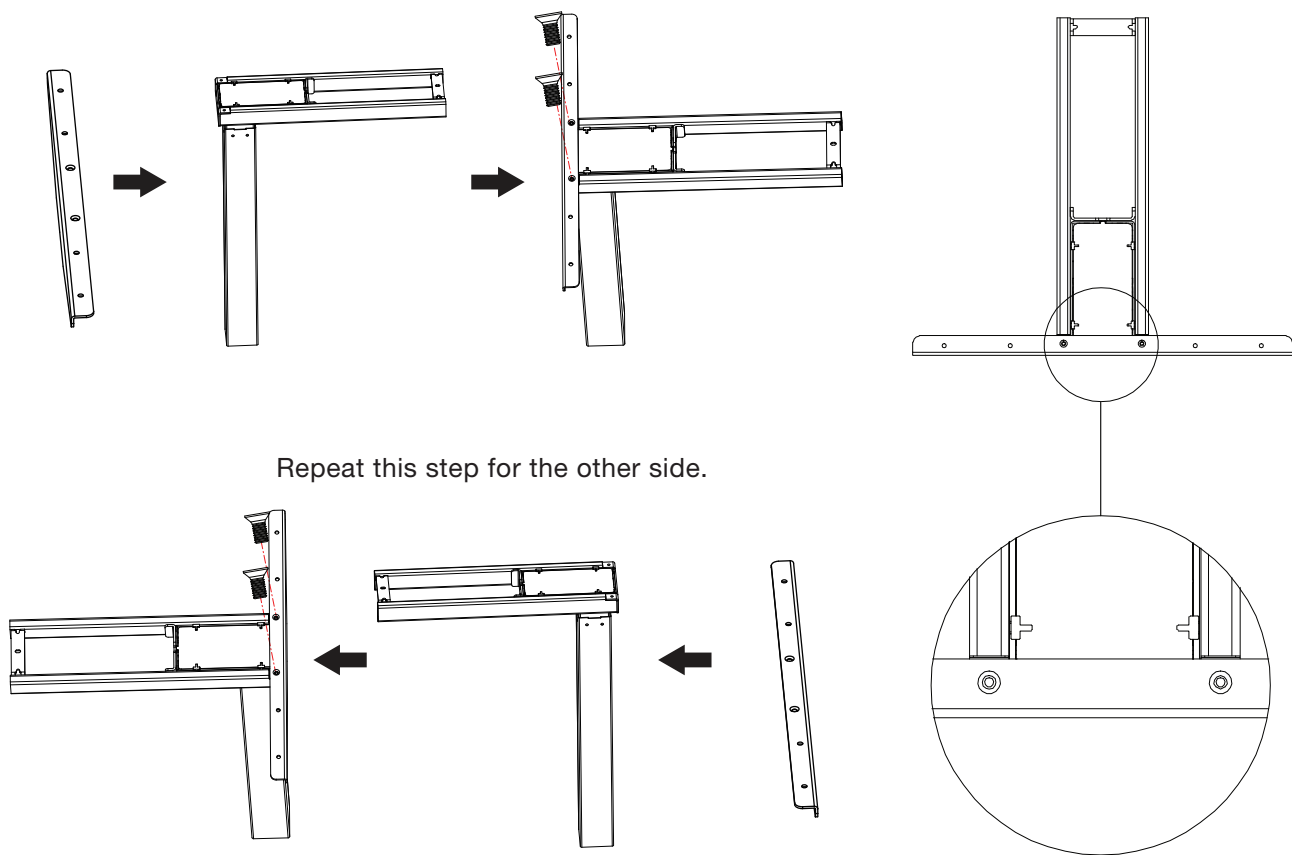

Step 4

Slide the two Crossbar Rails (P4) back into the two Crossbar Ends (P3).
Please make sure the slots in the Crossbar Rails face inward like in the photo below.

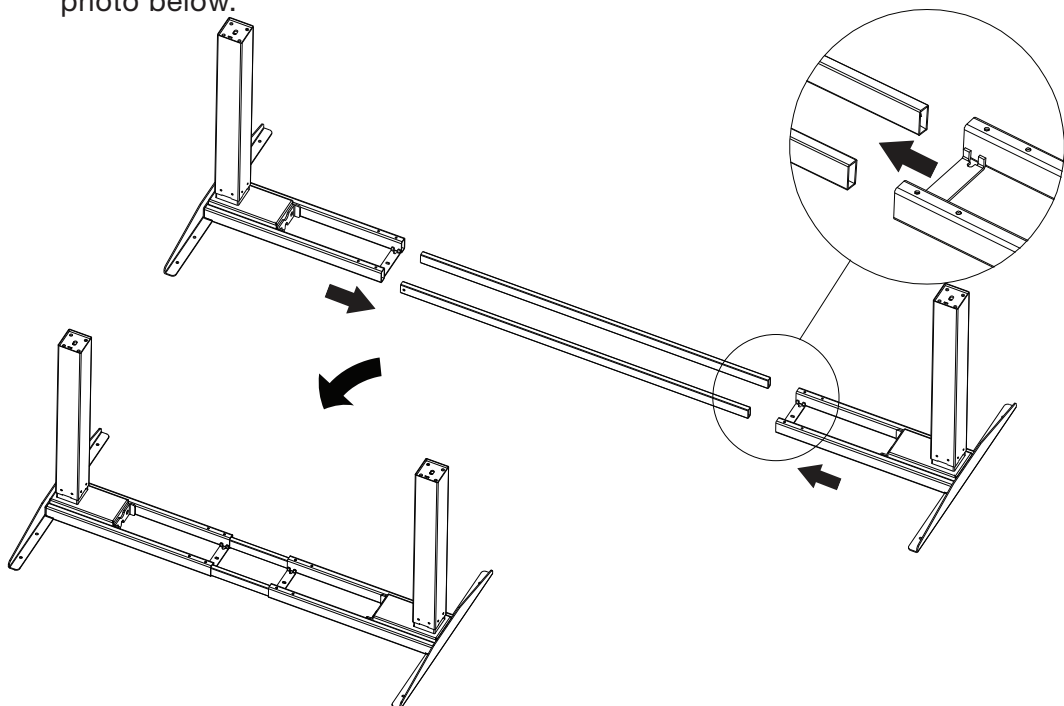

Step 5

Attach the Feet (P2) onto the Legs (P1) using 8 M8x16 screws (A view).

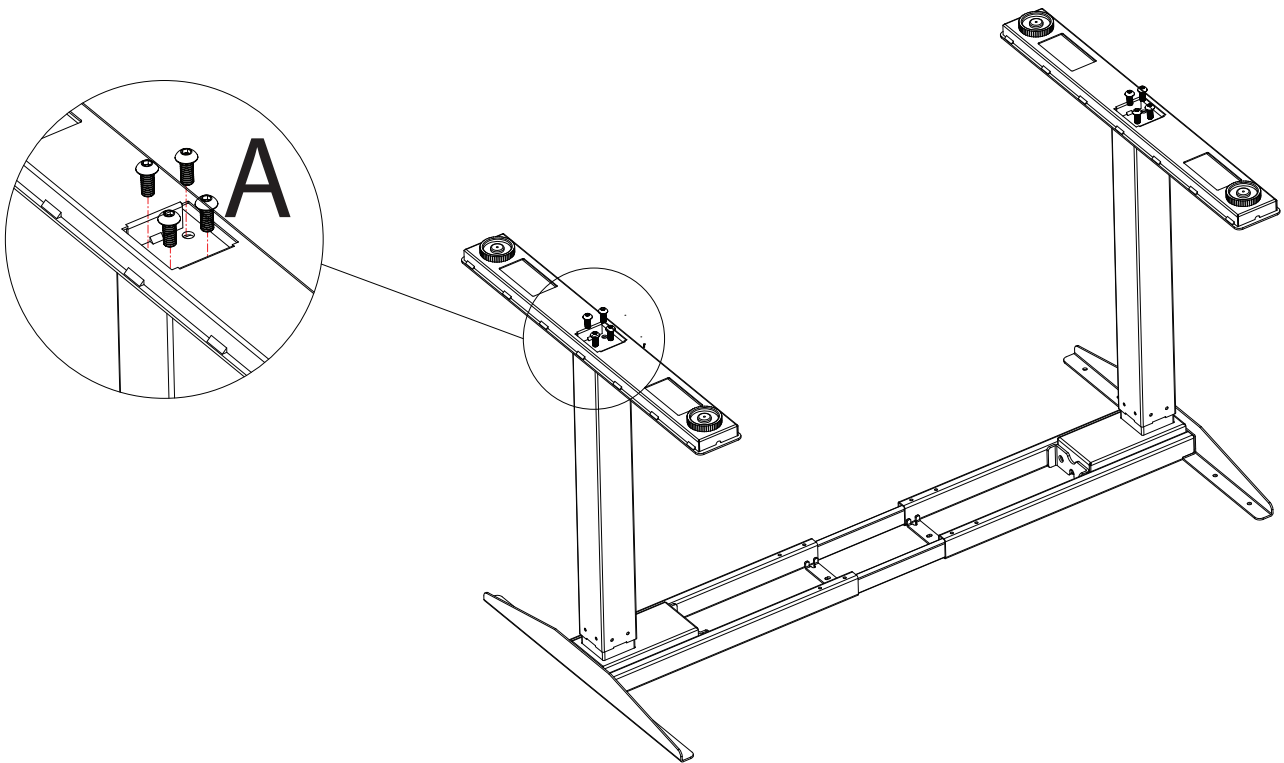

Step 6

Attach 12 Noise Pads to the 12 holes on the frame - 4 for each Side Bracket and 4 at the center.

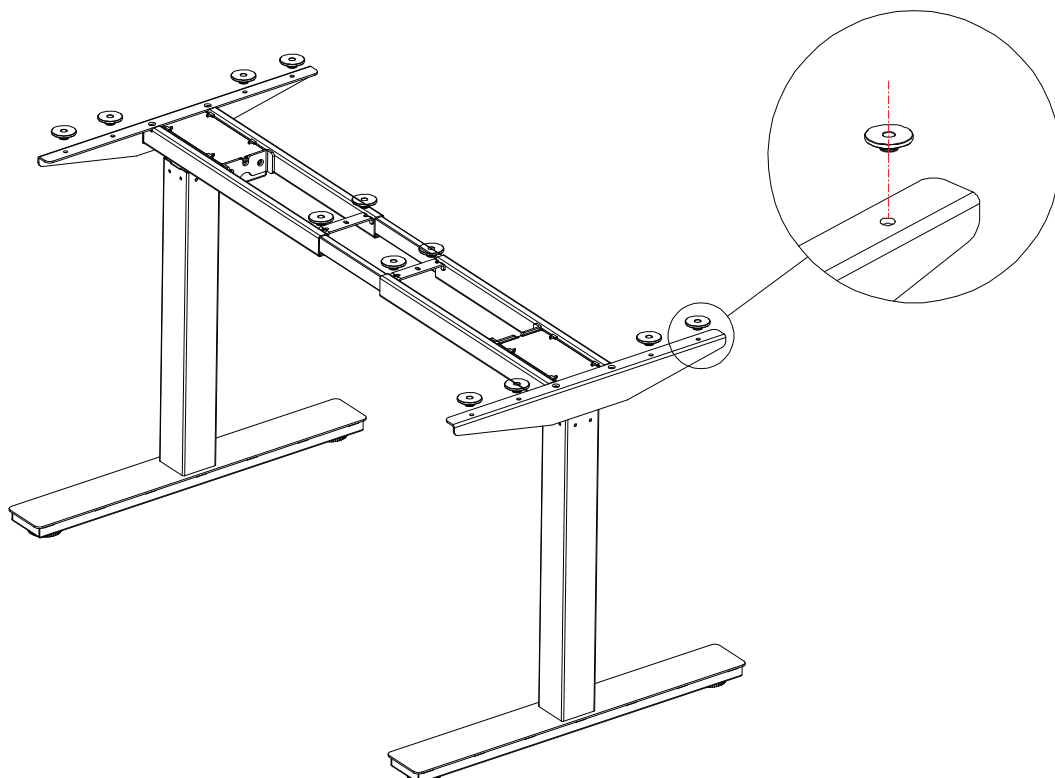

Step 7

Line up the side bracket with the pre-drilled holes facing upwards.
Firmly secure the frame to the table top using ST4.8x19 wood screws
- 4 for each Side Bracket and 4 at the center.

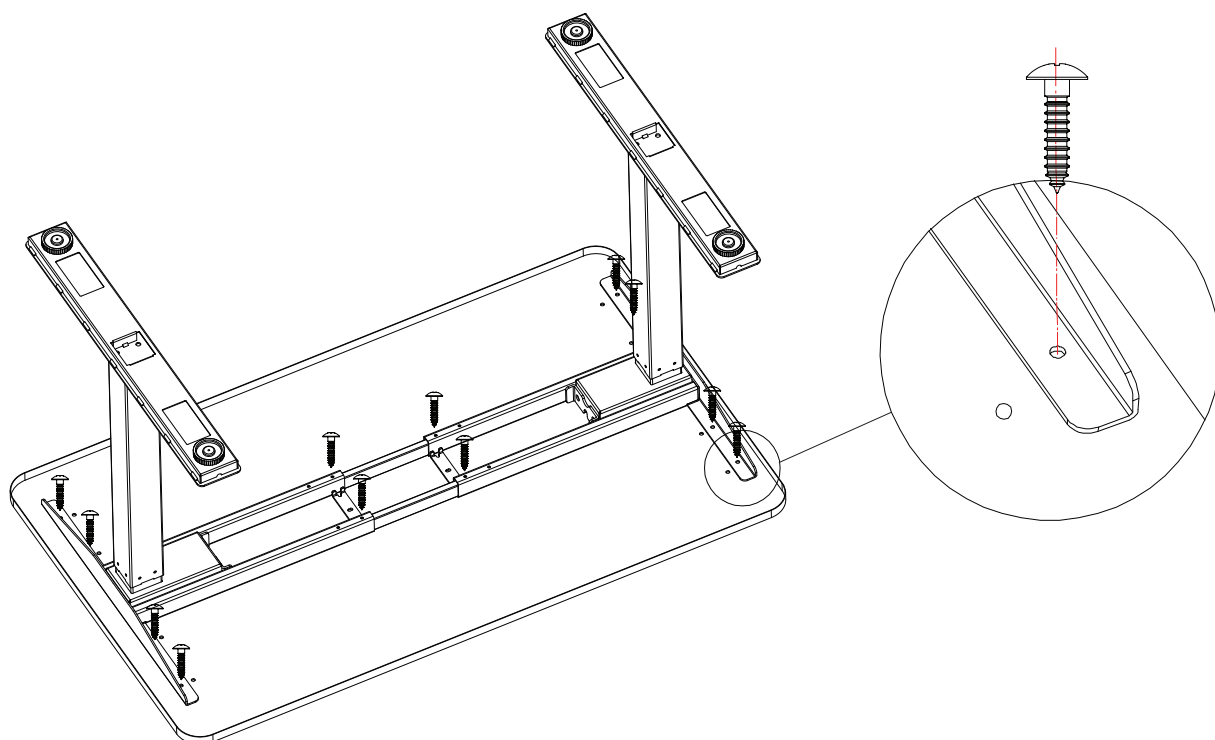

Step 8

Attach the Control Box to the top using two ST4.8x19 wood screws.

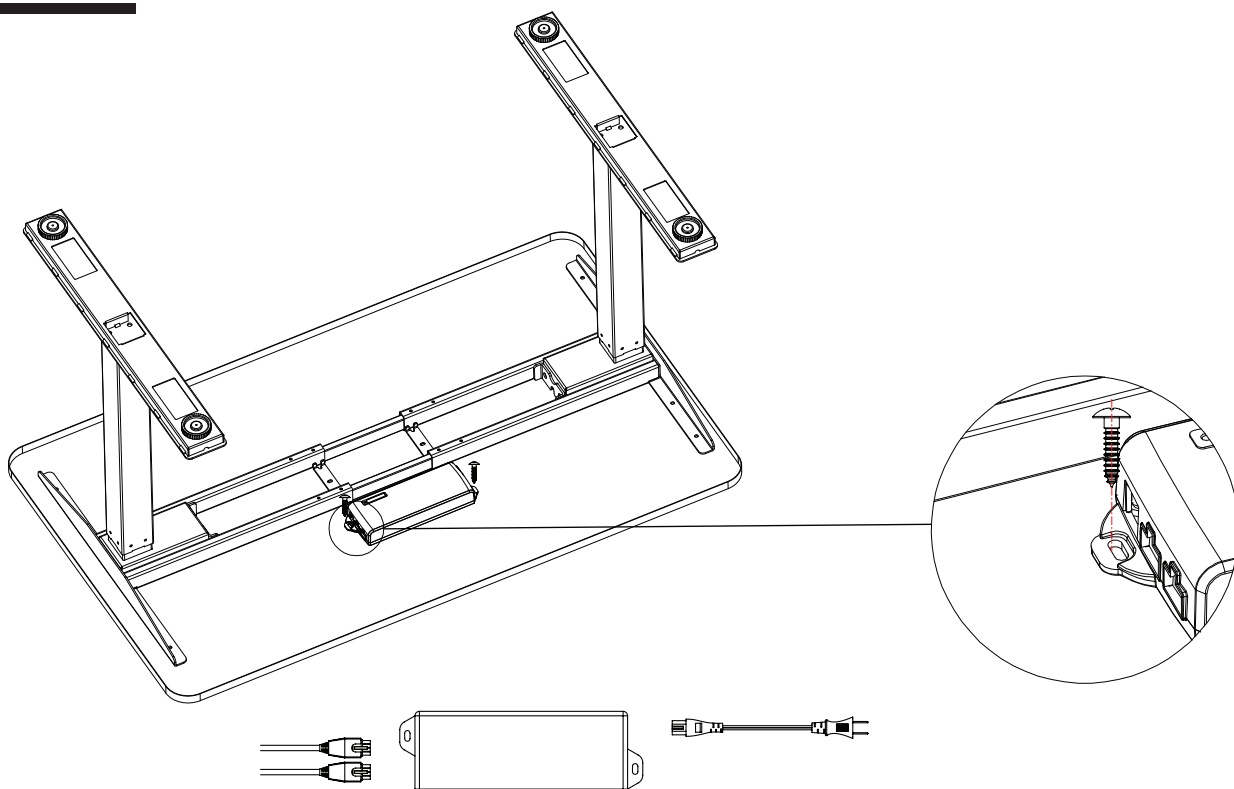

Step 9

Attach the Cable Tray (if any) to the frame using 4 M6x12 screws for the Cable Tray.

Place the Control Box on the Cable Tray.

Plug cables from the two motors into the Control box.

Plug the Power Cable into the other side of Control box.

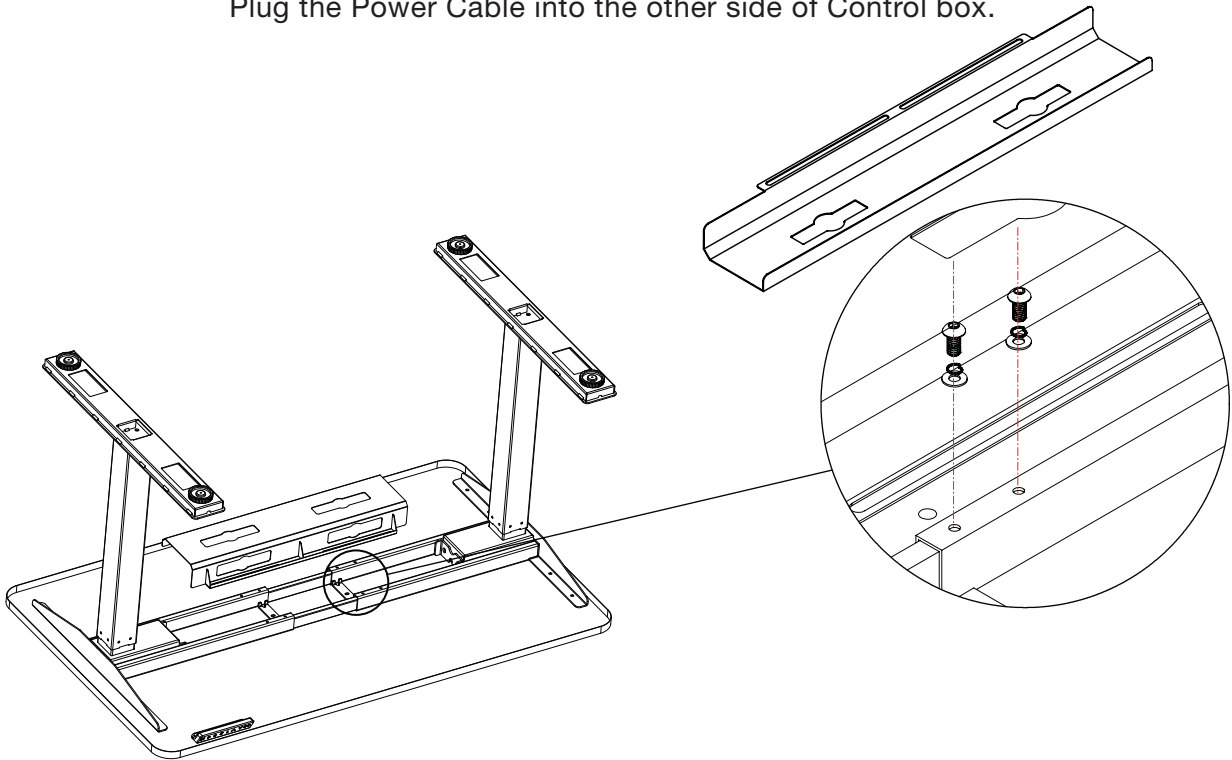

Step 10

Attach the Keypad (P9) using 2 ST3.5x19 wood screws.

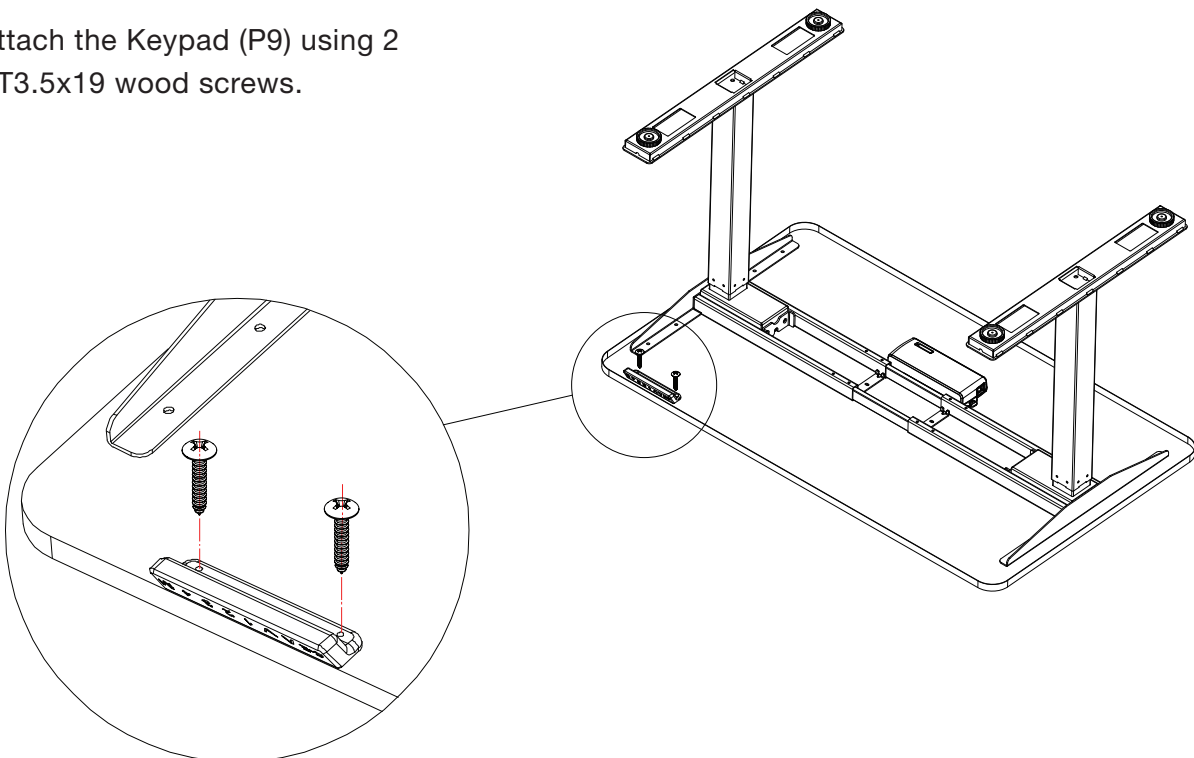

Step 11

Plug the cable from the Keypad (P9) into the Control Box and flip the desk.

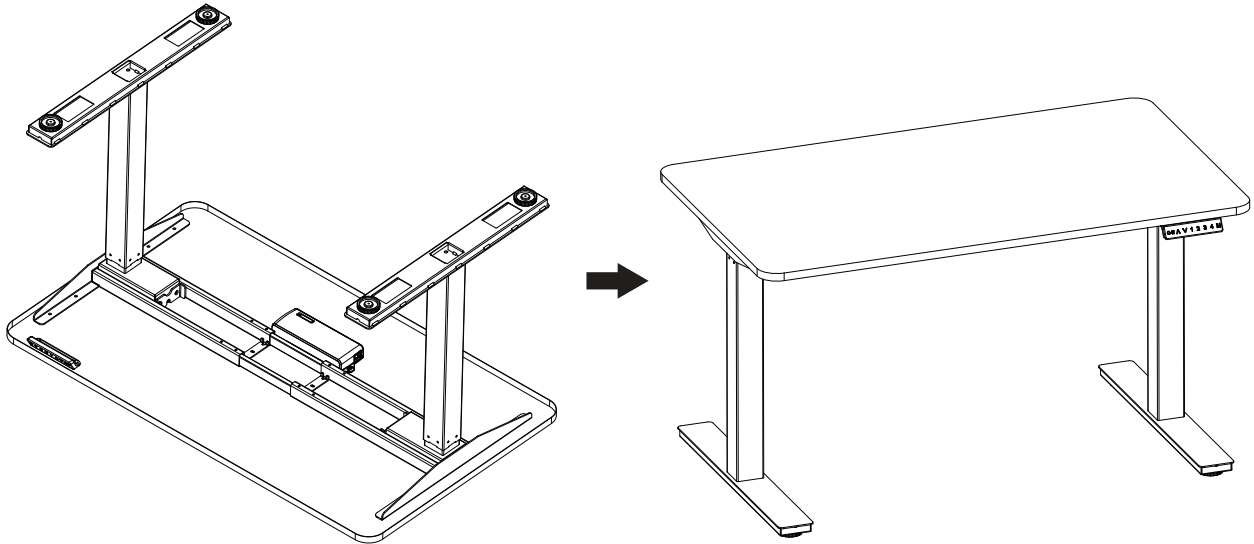

Step 12

Before plugging the table into the outlet, make sure that:

- The legs are level and set at the lowest position.
- All the screws are tightened, to avoid the desk making noise or wobbling.

Activate the desk by following the next steps:

- Press “Up” and “Down” buttons at the same time until the desk beeps and moves down to the lowest level.
- Release both buttons, then press only the “Down” button until it shows the exact height desired.

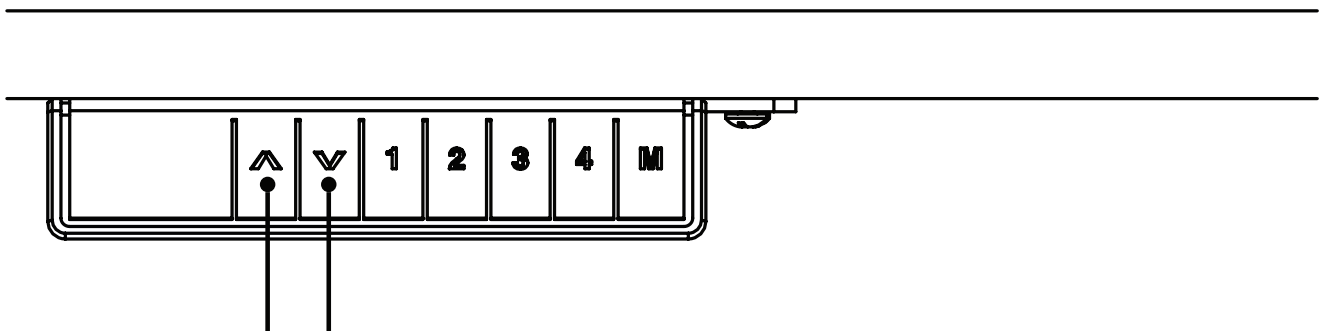

Operation guide

1. Adjust SmartDesk's height

Press the “Up” or “Down” button to adjust the height of the desk.

2. Program preset buttons

To use the presets on the SmartDesk, please follow these steps:

- Set the desk to the height you like.
- Press the M button until the LED flashes.
- Press the number you want the desk set to.

3. Reset the desk

- Unplug the power cord from the control box.
- Unplug the cable that links the keypad to the control box.
- Plug all the cables in again.
- Do the reset: Press “Up” and “Down” buttons at the same time until the desk beeps and moves down to the lowest level. Release both buttons, then press only the “Down” button until it shows the exact height desired.
- Your desk is ready to use.

Autonomous

smart office

www.autonomous.ai
human@autonomous.ai